

FLE HOA Happenings

“YOUR VOICE IN THE PARK”

EditorFLEnewsletter@gmail.com

Forest Lake Estates, Zephyrhills, Florida

November 2020



*On November 11, 2020 at 11:00 am
We Will Gather to
Honor Our Veterans*

Message from the Desk of Carolyn Keithley

Forest Lake Estates Homeowners' Association (FLE HOA) President

Welcome back to all our snowbirds from across the country. It is great to see old friends returning and I look forward to catching up with everyone. Hopefully we will see our Canadian friends returning soon. We are continuing to meet with the ELS management team monthly in an effort to resolve some of the concerns we have about our park. We have recently submitted a letter to the regional VP and to the corporate office in Chicago and are waiting for a reply. We will keep you updated as things change or develop.



Mike Reid, activities director, coordinated with Julie Glenna, social director, to submit our business plans for Monday Night Sandwiches and the Ice Cream Social. All of the plans we submitted were approved by regional manager Sydney Morris, so we are moving forward with planned activities for the community. Please be sure and check out the activities calendar in this month's newsletter.

The 360 inspections began in early October and should be completed by this writing. I have not heard of any follow up letters being sent to our residents, but we were told that follow up would occur once the inspections were completed. The new call box system at the front gate should be installed very soon. This should enable anyone coming into the park to easily locate and contact the parties they are here to visit.

What great news! The pool hours have been extended and we are open seven days a week, and we are back to using our clubhouse! What a great feeling it is to see some normalcy returning to our community. It is, however; unfortunate that we will not be able to host our annual Thanksgiving Dinner this year. It just means that we will be looking forward to next year and enjoy it even more.

I have received a letter of resignation from Julie Glenna, our Social Director, effective December 30, 2020. Julie has done a wonderful job over the last year. Together she and her husband Jerry have handled ticket sales for dinner dances and any event that ticket sales were needed for. I want to thank both of them for the time they have given to the residents of our community. If anyone is interested in the position of Social Director, please let any member of the board of directors know. We will also be looking for someone to chair the ticket sales. Yes we work hard for this community, but I find it very rewarding to know that we can assist you to make things better.

So, hopefully we begin to see you at our events in the clubhouse and throughout the park in the next couple of weeks. Just remember that masks must be worn while in the clubhouse, practice social distancing and use hand sanitizer. Lets all work together to bring our park back to the normalcy we know and enjoy.

Happy Thanksgiving to everyone,
Carolyn Keithley, FLE HOA President

Forest Lake Estates Homeowners Association (FLE HOA) Officers and Board of Directors

President: Carolyn Keithley
flehoasocialdirector@gmail.com
813-602-8978

Vice President: Mike Black
michaelvp0311@gmail.com
740-334-5042

Secretary: Wendy Coache
flehoa.secretary@gmail.com
813-395-5650

Treasurer: Jan Swanson
janswan22@aol.com
734-765-0767

Director: Larry Shapiro
lshapiro@outlook.com
607-346-0217

Director: Mark Matthews
mmatthews6225@gmail.com
813-778-3377

Director: Mike Reid
fleactivitiesdirector@gmail.com
413-824-5426

Director: Janice Collins
flehoa.membership@gmail.com
813-788-5678

Director: Julie Glenna
flesocialcommitteechair@gmail.com
813-788-9065

Chairpersons:

Activities: Mike Reid
Membership and
Resident Directory: Janice Collins
Welcoming: Trudy Ansel
Social Committee: Julie Glenna
Recycling: Larry Shapiro

Newsletter:

Email: **EditorFLEnewsletter@gmail.com**
Editor/Layout: Wendy Coache
Advertising: Mark Matthews
Calendar:

Proof Readers: Joan Kubara
Bev Onken

PLEASE NOTE: Email address for the
newsletter

EditorFLEnewsletter@gmail.com

From our Social Director—Julie Glenna

Happy Fall. To our US residents returning, drive safe and we look forward to seeing everyone again.

We all have shown great strength and respect for each other during this pandemic. Your diligence in following the guidelines set forth by ELS, as well as the state and national regulations, has kept our community safe.

Thank you.

The HOA Board has been constantly working with our resident management team to get activities going again. We have submitted plans to them for several activities and have received approvals to begin several different activities. We will continue to work with them on your behalf.

Our Canadian friends and family are dealing with a border that, as of this time is closed through November. Due to the restrictions currently in place, our annual Thanksgiving Dinner and our Saturday Night Dinner Dances will not take place in the month of November. We will all miss the wonderful dinners and the chance to get together with friends. We wish you all our sincere blessings for a wonderful Thanksgiving holiday.

The good news is that we continue to submit plans to community management and we are happy to say that Monday Night Sandwiches and Ice Cream Socials have been approved and will be moving forward.

Due to the current restrictions, masks will be required and social distancing must be practiced using the table layout done by ELS. The maximum capacity in the clubhouse at one time is 100, this includes attendees and kitchen staff.

New Procedure for Monday Night Sandwiches:

Our first Monday Night Sandwich night will be on Monday, November 9th. Advance tickets are required and will be sold on Monday, Nov 2nd and Tuesday, Nov 3rd from 10:00 to 12:00 noon.

On November 9 you will come to the clubhouse between 4:30 – 5:30 pm and give your name to the person(s) out front. We will pull your order and process it for you. **Please come gradually throughout the hour as to allow for everyone to move along in a timely fashion.** You can choose to eat in or take out. Maximum capacity in the clubhouse is 100 people at one time. That number will also include those preparing the meal for you. To accommodate more residents we are limiting the number on the teams during that hour to allow as many people in as possible. Once you have finished eating, we ask that you wipe down your table using the anti-bacterial wipes & spray which are placed around the clubhouse. We appreciate your help with this.

We are following the guidelines used in restaurants with all pre-packaged condiments and silverware. Your lemonade and coffee will be given to you from the kitchen window, along with your meal. We were able to keep our same pricing from last year.

Our Menu:

Hamburger/Cheeseburger w/ potato chips	\$5.00
Chicken Sandwich w/ potato chips	\$5.00
Brat w/ potato chips	\$5.00
Hot Dog w/ potato chips	\$4.00
Soda & Water	\$1.00

Apple Sauce can be substituted for the chips at no extra charge.

(continued on page 4)

From our Social Director (continued from page 3)

Ice Cream Social

Our first Ice Cream Social will be held on Sunday, November 15th. Advance tickets are required and will be sold in the clubhouse on Monday, Nov 9th and Tuesday, Nov 10th from 10:00 to 12:00 noon. The Menu will be available to you at the time of purchase of tickets. Prices will remain the same as last year.

A reminder that masks will be required and social distancing must be practiced using the table layout done by ELS. We also have a maximum capacity of 100 people. When you arrive, someone will pull your orders and they will be made for you. You can pick them up at the window as usual when your name is called out.

To allow others to enjoy their ice cream goodies, please assist us in wiping down your tables with the wipes and spray provided.

Both menu's will be posted on the bulletin board outside the clubhouse screen room prior to the start of ticket sales.

Let's enjoy the amenities and socializing that are starting up. We hope to be able to provide more events in the near future.

Julie Glenna

Social Director

Nola Sawtelle, former resident of Forest Lake Drive, on October 2, 2020

Sophia Ward, former resident of Utopia Drive, on October 4, 2020

Virginia Harvey, former resident of Spring Lake Circle, on October 5, 2020

Doris Bitel, former resident of Utopia Drive, on October 6, 2020

Robert (Bob) Zimmerman, of 6313 Jessup Drive, on October 15, 2020

In Memoriam

Lending for Little Ones

It's nice to be prepared for our little visitors. Lending for Little Ones is still here. We currently have people signed up with a variety of items that are available to lend to others. We can meet most needs. We have strollers, porta cribs, car seats, water wings and much more.

We still need volunteers who are willing to lend items to others. If you are able to lend items, please contact me so that I can add your items to the list. If you need to borrow something we will try to accommodate you.

Those interested in lending or borrowing, please contact me at 813-753-7099 or email me at ann.kubiet@gmail.com.

Thank you, Ann Kubiet



Message from the Management Office



Forest Lake
6429 Forest Drive
Zephyrhills, FL 33540



Frequently asked questions:

Q: How do I let my guests in the gate?

A: You will provide your guest with your 4-digit gate code prior to their arrival. Once your guest is in the visitor lane at the entrance, they will enter your assigned 4-digit gate code in the call box, a call will be sent to the phone number you provided upon moving into the community, once you answer the phone you will have to press (9) from your phone to grant them access into the park.

Q: I followed the directions and for some reason the gate wouldn't open! What do I do?

A: We understand the gate can be quite confusing sometimes, so here's what you can tell your guest: "The office is open 8:30AM-5PM Monday-Friday just put in the gate code that's listed on the green sign on the call box, identify the resident you are coming to see and they will let you in."

Q: I don't use my phone often and I never hear it when it does ring... What am I supposed to do?

A: Refer to the answer above.

Q: Am I allowed to obtain a barcode for a friend or relative?

A: No, barcodes are for resident use only and should not be used by any family members, or friends.

Q: Where can I purchase a key fob?

A: You can purchase a key fob from the Forest Lake Estates management office for \$25 each, all you need to do is bring the acceptable payment method which is a check or money order made out to Forest Lake Estates and an official document with your address on it.

Q: How do I obtain a new barcode?

A: You can obtain a bar code from the Forest Lake Estates management office for free, all you need to do is bring your current up to date drivers license, and the valid vehicle registration for the car that needs a new barcode. One of our community representatives will be more than happy to install for you.

10/2020

NEWS FROM THE MEMBERSHIP DESK:

Greetings to all HOA members. A new year will be dawning soon and I hope it will be better than the last 8 months have been.

I will be kicking off the sale of the 2021 HOA Memberships on November 2nd at the clubhouse from 10am to 12noon.

With the threat of Covid-19 still around, we understand that many of our residents will not be coming to Forest Lake Estates this winter. Because all memberships expire on 12/31/20, that means anyone who has not paid the HOA membership fees, their membership will be terminated. I would like to recommend that members that are unable to return before the end of December, complete the Membership form (form can be found on page 7) in the newsletter and mail it to the address on the form, along with a check for \$20 per household, payment made to Forest Lake Estates HOA. I will then issue you a membership card and hold it until you can pick them up from me when and if you can come to FLE this winter. By keeping your membership active, you will continue to receive the newsletter, all email announcements and meeting minutes, once meeting have resumed.

For residents in the park, you can come to the clubhouse on Monday mornings to get your new memberships or drop off your form and money in the blue box on my front step.

Janice Collins, Director and Membership Chairperson

Come and Get It! Your First Ice Cream Social this Season

Sunday, November 15, 2020
6:00 – 7:00 PM

Come join family, friends, and neighbors at our first Ice Cream Social of the year. Due to COVID restrictions, advance tickets are required. You can peruse the menu and purchase your tickets in the clubhouse on Monday, November 9th and Tuesday, November 10th between the hours of 10am and noon. Hope to see you all there.



BLOOD DRIVE—NOVEMBER 14TH

In the Clubhouse parking lot from 8:30am—1pm

Due to the Coronavirus, they are requesting that appointments be made at

https://donor.oneblood.org/donor/schedules/drive_schedule/82350

If you can't make an appointment before the 14th, they will still take walk-ups but there will be a wait.

When you donate you will receive a blanket and a \$10 e-certificate usable at Walmart, Amazon and others.

COVID19 Antibody test included.



2021 FLE HOA MEMBERSHIP CAMPAIGN

“YOUR VOICE IN THE PARK”

The purpose of the Forest Lake Estates Home Owners' Association (FLE HOA) is to ensure our membership and our perspective members are aware of the goals of our Association. We are now conducting our 2021 Membership Campaign.

Our mandate is to:

- Operate an Association encompassing the well-being of the business affairs of the Forest Lake Estates Home Owners' Association.
- Promote FRIENDSHIP and HARMONY between FLE HOA and the Park Owners, ELS .
- Ensure rent increases are REASONABLE AND WORTHY; and,
- Ensure ELS is in compliance with 723 F.S., the Prospectus, and all exhibits thereto.

While it is important to maintain a harmonious relationship between FLE Residents and ELS, it is also important to know that the FLE HOA stands firm on these mandates. All Forest Lake Estates residents have an investment that must be protected. The FLE HOA is the ONLY entity recognized by the State of Florida to represent all of the residents in the Park. The HOA works with ELS to assure that the park is maintained appropriately and to protect the best interests of all residents. All residents are encouraged to join the HOA and support the HOA Board of Directors as they work to support you. From November through Mid-January, membership sales are held in the clubhouse on Mondays from 10:00AM until 12 Noon. The dues are \$20 per household per year and are deposited into our general fund to be used for operating expenses, activities and legal support. Members who provide an email address will receive the monthly newsletter, minutes of membership meetings and any announcements via email. You may choose to have a hardcopy newsletter delivered to your home November to April. Newsletters are only delivered in the summer to members without email. Board Members are elected each year in January. You must be a paid member to be eligible to run for a seat on the board and to vote in the election.

ASSOCIATE MEMBERSHIPS are available for Renters only

Associate Members will have all the benefits of Members but cannot run for election or vote. The fee is \$15.00 per household. Please contact Janice Collins for the application. (813-788-5678). The Associate Member Form is different from the HOA Membership Form.

FLE HOA MEMBERSHIP – 2021

Name (1): _____ Phone # _____

Name (2): _____ Phone # _____

Forest Lake Address: _____ Lot Number _____

Full time Resident Seasonal Resident

Email Address (1): _____ Email Address (2): _____

Newsletter Delivery: Email Home Delivery Both Home State/Province _____

OPTIONAL: providing the following information authorizes the HOA to publish the dates in the newsletter.

Birthday (1) _____ Birthday (2) _____

Anniversary _____

Please complete this form and mail or drop off with the fee of \$20 per household: FLE HOA Membership C/O Janice Collins, 6346 Spring Lake Circle, Zephyrhills, FL 33540 813-788-5678

Did You Know

Household trash collection is a free service. During Winter, November 1 thru 1st Monday in May, trash is picked up Monday and Thursday for houses below Ritchie Lane. Above Ritchie (closer to clubhouse) pick up is Tuesday and Friday. Summer hours May 1st to November 1st, collection days are Monday and Thursday for all streets. Trash must be bagged and in covered cans and should be put out by 7:00am. If you set bags out at night, they may be “opened” by critters. All yard clippings need to be bagged or tied, no longer than 4 feet long. All cardboard boxes must be flattened and tied together. TVs and appliances will not be picked up.

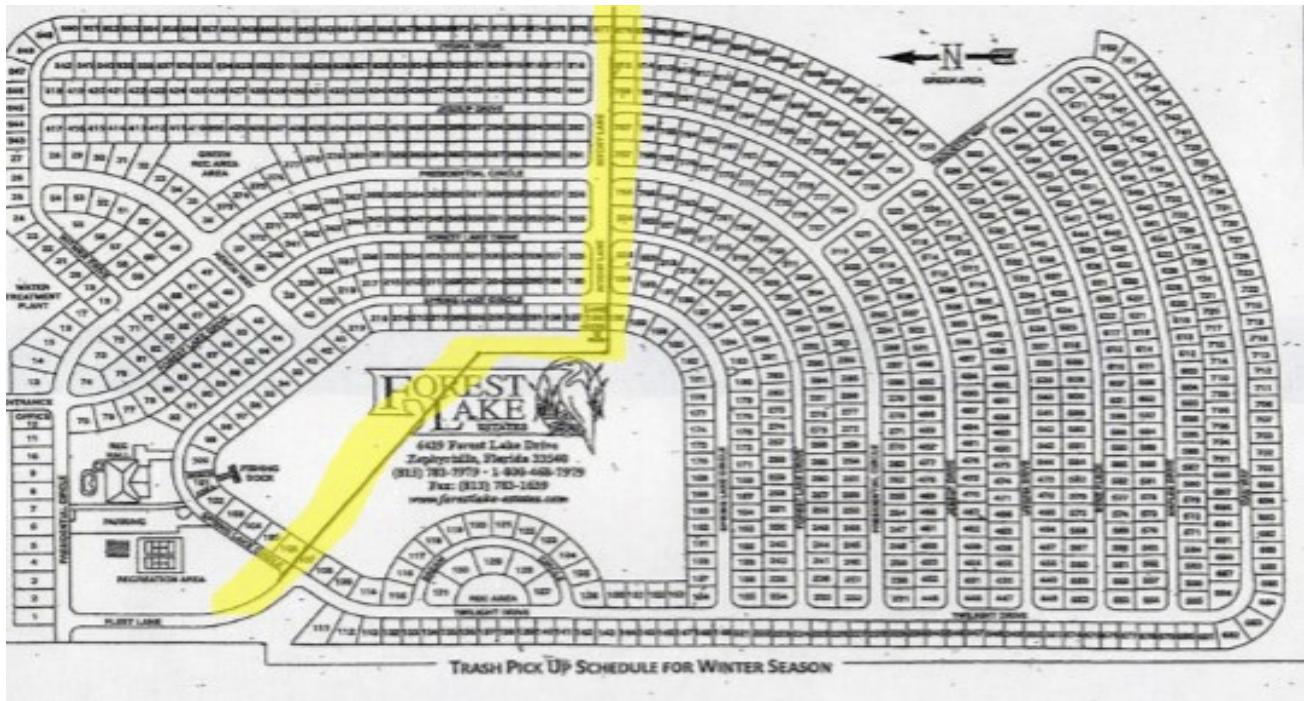

Ask The HOA

Question: submitted by Julie Smith, Lot 123

Why if we pay more to live on the lake do we get less lawn service ie weed wacking at waters edge only once a month

Answer: Julie, thank you for your question. This issue has been discussed with ELS a number of times. The last time it was discussed was at the August 27th meeting of the HOA Board and ELS. At that meeting, we had photos and suggested that the trimming take place more often and closer to the lake. We were advised that the lawn care vendors are paid to trim to the water's edge. ELS agreed to discuss this with the vendor. If you continue to see issues, we can now only suggest that you complete a Resident Concern form, bring it to the office, make sure to get a signed/dated copy for yourself and the HOA board. Once the concern is registered with the office, we can then follow up when we meet with them.

Do you have a question you want answered, submit it by November 15th to

EditorFLEnewsletter@gmail.com

If we have the answer, we will share it; if we don't, we will work to get the answer for you..

Veterans Day 2020 November 11, 2020 at 11AM



Come help us say a big Thank You to our vets at our annual Veterans Day Ceremony, November 11th , 11:00AM, in Memorial Park. We are limited to 100 vets and family in the park. We will have road closed between the Clubhouse and Memorial Park for those who wish to stay on their golf carts. We will have a small gift for all our Vets as a token of appreciation for their great service. This year's ceremony is being hosted by Jim Dill and Mike Bodenheimer. Please be in place not later than 10:50AM as we will start promptly at 11:00.

COVID RESTRICTIONS: Masks and social distancing are required.



ANNUAL FOREST LAKE ESTATES CRAFT FAIR

The date for the 2020 fair is December 5, 2020. Nancy Matthews is the Chairperson for the annual event and this year is asking for volunteers to serve on a committee to help host this event. Being a member of the committee would involve preparing for the event, including set up on Friday evening, December 4th and cleaning up at the end of the event.

CRAFTERS— Due to limited space, applications to participate will be available from Nancy Matthews in early October. The cost to rent table space is \$10 for a FLE resident and \$15 for all others.

If you have questions, please contact Nancy Matthews at 813-469-1303.

Christmas Card Delivery 2020

Christmas Delivery Elves will be busy delivering Christmas cards from December 7th through the 21st . Those wanting to send Christmas cards to their friends should place them in labeled box on the table in our clubhouse. Sorting and delivery will be done by the Christmas Delivery Elves.

Elves, please contact Pam Eilts at: 815-685-1510 or Dana Parker at: 815-735-3216 if interested in volunteering as Christmas Delivery Elves.

Residents, please do the following:

*Provide basket, bag, or designated holder to receive cards.

*Please include return address on each card.

NO STAMPS ARE NEEDED!!!



**Please Support
Our
Local Advertisers**

**Will Do Odd Jobs
Interior / Exterior**

- ✘ **Yard Work**
- ✘ **Painting**
- ✘ **Home Repair**
- ✘ **Gutter Clean-Out**
- ✘ **Opening & Closing of Seasonal Homes**
- ✘ **Off-Season Home & Yard Maintenance**



**Power Washing:
Houses, Roofs, Sidewalks**



**Airport & Cruise Transportation
Tampa / St. Pete / Orlando**



**Mark Matthews
813.778.3377**

AIR CONDITIONING & ELECTRICAL CONTRACTORS



CHRIS' A/C
HIGH EFFICIENT HEATING & COOLING
COMPANY
12232 US HWY 301 DADE CITY, FL 33525

Chris & Christina Jones
Owners

DADE CITY 352-521-4977
ZEPHYRHILLS 813-779-9515
www.chrisaccompany.com

LIC# CAC058575
LIC# EC13007703



**O'Donovan's
Company**

AIR CONDITIONING & HEATING
Sales - Service - Maintenance

(813) 782-4075

4839 Allen Road, Zephyrhills, FL 33541
Licensed, Insured, State Lic. CA C054731

MOBILE HOME DEPOT
Parts Warehouse

- Doors • A/C Units • Low-E Windows
- Water Heaters • 54"x27" Tubs / Showers

These Products & More!!!

5409 Gall Blvd Zephyrhills • (813) 702-6293

www.mobilehomedepot.net

Buzz's Pressure Washing, LLC is a family owned & operated local business.

We specialize in:

Manufactured Homes • RV/Pool Cages • Pool Decks
Driveways • Sidewalks • Paver Blocks



- 1 Pre-chemical plus any spot cleaning necessary.
- 2 Hand brush siding & windows with special soap & water.
- 3 Low pressure wash & rinse.
- 4 Spray home with wax sealant.
- 5 Squeegee windows.

We are fully licensed and insured.

Call to set up your appointment today!

**"Blue Boots" Buzz
813.702.2170**

Buzz's
Pressure Washing
LLC



...Some News about Activities and Events

From the desk of Mike Reid, Activities Director:

To all those who have returned or will be returning in the near future, welcome back! To those who may not be returning due to restrictions, know that you will be missed. After a long, crazy 7 months, we are finally getting some of our activities back. We have calendars. If you don't see your activity on the calendar, please let me know. In accordance with the rules established by ELS, participants of any activity that is held in the clubhouse, must wear masks at all times and practice social distancing as much as possible. Due to COVID restrictions, our larger social activities will be different this year. So please be patient with us as we work to get our activities running safely. If you have any ideas for a new activity or if you would like to run an activity, please let me know. We are always looking for good volunteers. Every idea is only as good as the one who thought it up, so please know that you will be asked to either be run the activity, or at least volunteer for it. Thanks for your cooperation!

I would also like to take the time to thank Donna Karakhanian for organizing all of the golf cart parades during the pandemic. With so little to do early on in the lockdown, having this nice, little diversion was fantastic for all of those who participated or cheered them on as they drove by. So thank you very much for stepping up and volunteering, Dee!

I'd also like to thank Debbie Prosser and Patsy Sokol for the addition of Sister's Rock to FLE!!! Whether you're searching for the latest finds, be they in person or on either their own Facebook page or the FLE Community Page, it has inspired so many in so many ways and at such an incredibly difficult time in everyone's lives. Thank you for the smiles, ladies!

Putt Putt

Social

Mondays at 6pm

No commitment, show up any or all Mondays.

\$1 to play, draw for partners. You cannot be paired with your spouse.

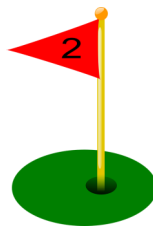

Who knew the joy rocks could bring



HALLOWEEN GOLF CART PARADE



Sorry for the late notice, we hope this gets out there in time for you all to participate. There will be a Halloween Golf Cart parade, on Halloween, Saturday, October 31st. Meet at the clubhouse at 6pm. Decorate your cart, wear your costume.

LET'S HAVE SOME FUN



...And Now Some Activities and Events

TEXAS HOLD 'EM

Every Thursday
6pm—9 pm
in the Clubhouse.
Must sign in by 5:50pm.
For further information

Call Mike Reid
413-824-5426

Masks and social distancing required



BINGO

We are ready to play

Bingo starts on Tuesday, November 17th

Card Sales will be from 4:45—5:45pm

Games start at 6:00pm

COVID RESTRICTIONS AS FOLLOWS

Masks required at all times

There will be 25 tables set for 4 players

Max in clubhouse is 100 people

Snack Bar will be available for prepackaged foods
only

Party Hardy Putt Putt 2020

New format due to COVID restrictions

League Play will be starting
the week of November 2nd

Full information and League Application Form
can be found on page 14

Contact Vince Boido at
rbigolfleague@gmail.com

Or

By phone at 813-843-1191



Park Wide Yard Sale and Bloodmobile

Saturday November 14th

Yard Sale hours are 8am—2pm

Bloodmobile hours are 8:30am to 1pm

Gate will be open from 8am—2pm

COVID RESTRICTIONS

Sales are at individual homes only

No more than 10 people at your home at one
time, please social distance as much as possible.





MOBILE HOME SPOT
Always At Your Service



**LAURA
MAHON-TINSMAN**
Local Agent

813-701-4991

Laura@MobileHomeLaura.com
www.MobileHomeLaura.com

TRACI JOHNS
Local Agent

404-729-5261

Traci@MobileHomeTraci.com
www.MobileHomeTraci.com

The **BEST CHOICE** for
Buying and Selling Homes at
Forest Lake Estates and
Forest Lake Village RV Resort!

We are **YEAR ROUND**
Community Residents!

Available 7 Days A Week!



1-844-888-SPOT (7768)
www.MobileHomeSpot.com



PARTY HARDY PUTT-PUTT LEAGUE, OUR NINTH SEASON 2020-2021

Vince Boido, e-mail: rbigolfleague@gmail.com or text at 813-843-1191

It's time to start planning for our ninth season of Putt-Putt. Due to covid 19 concerns, social distancing will come into play this year and our league format has changed. Hopefully we will have enough interest so that I can carry out the new plan. 20 teams filling out for separate divisions will be scheduled on Mondays 3:00 to 4:10 PM, Wednesdays (two sessions early & late) will be scheduled at 3:00 to 4:10 PM, (early) and 4:20 to 5:50 P.M. (late) and 20 teams will be scheduled on Fridays 3:00 to 4:10 PM. The first scheduled week will be Monday November the 2nd, Wednesday the 4th (early and late), and Friday November 6th. Sundays will be make-up by appointment only. For skins purposes, Sunday will be considered the end of the week. Please contact me via e-mail or text before October 21st to let me know which day/time slots that you are available to play. If you are able to play on more than one time slot please let me know, I could use as much flexibility as possible. Tee times will be printed at the start of the season. There will be ten minutes between tee slots and every team will now be scheduled to play head to head competition with another team from the same division. Please cooperate by letting me know when you plan on arriving at FLE and when you are available to start as well as what division you can play. Make-up plans are in place, if you cannot arrive on time you will have the opportunity to play your matches.

Every match will provide for teams to earn points. Scores will be considered Net Score with the same previous year's handicapping system to apply. Points will be earned as follows: Win- 6 points; Tie - 3 points; Loss - 2 points; and 1 point for every hole in one. No points for forfeited matches (begins Feb.1st).

League fees have been reduced to \$15.00 per player, \$30.00 per team. Skins are still a mandatory \$1.00 per person and we have a carry-over from last season (\$310.00) to begin our season. With the new scheduled tee times only four players would come within the 6 feet contact spacing, this should not be an issue.

Please contact me asap, I have a lot of work ahead of me and need to set up the league. I am looking forward to seeing all of you soon. Vince Boido, rbigolfleague@gmail.com or text/call (leave a message if I don't answer) at 813-843-1191.

LEAGUE APPLICATION FORM:

Player #1: _____	Player #2: _____
Name	Name
_____	_____
e-mail address	e-mail address
_____	_____
Former address (Can-Am. Purposes)	Former address (Can-Am.Purposes)
_____	_____
FLE ADDRESS	FLE ADDRESS
_____	_____
TELEPHONE #	TELEPHONE #

What days are you available to play? Monday, Wed (early), Wed (late), Friday (Circle one or more)

Please list the date when you plan on starting: _____

COMFORT COVERSYSTEMS
Proudly roofing since 1985



Roofing System

- * Insulated Energy Star Rated Roof
- * Manufacturer's Backed Lifetime Warranty
- * Financing Available
- * STOP Roof Leaks

Single-ply roofing membrane toughened with Evaloy resin modifiers from DuPont
Visit our website at comfortcover.org
FREE ESTIMATES
1-800-226-0955

LOCALLY OWNED & OPERATED

A COMPLETE PEST CONTROL SERVICE



"OVER 50 YEARS EXPERIENCE"

J.C. "CHRIS" BOLTIN, ENTOMOLOGIST

Founded By University Of Florida Graduate:
H.H. "BO" BOLTIN, JR., ENTOMOLOGIST
'Our Real Estate Inspections Meet State Requirements'

352-567-2395
TOLL-FREE: 1-888-272-2871

www.boltinpestcontrol.com
15534 US 301, Dade City, FL
A DRUG-FREE WORKPLACE

FFMA FLORIDA PEST MANAGEMENT ASSOCIATION INC. NATIONAL PEST MANAGEMENT ASSOCIATION (NPMA) INTERNATIONAL

PLEASE SUPPORT OUR ADVERTISERS



AIRPORT RUNS

MARK HEIFNER	PORT OF TAMPA \$40.00
6334 JESSUP DR.	TAMPA INTERNATIONAL \$50.00
813-713-6662	ST. PETERSBURG \$60.00
CAR / VAN	ORLANDO INTERNATIONAL \$75.00

RONNIE'S CARPETS & FLOORING

**12348 US HWY 98 N
LAKELAND, FL 33809
863-859-1441**

HOURS: 9-6 Mon-Fri 9-5 Sat

Water Proof Flooring

Ceramic
Wood
Carpet
LVT
Laminate
Vinyl

CARPET BINDING & Area Rugs

CARPET, TILE & UPHOLSTERY CLEANING

Since 1971

Free Estimates - Expert Installation
See our special buys and closeouts at
www.RonniesCarpets.com



Happy November Birthdays



- | | | |
|---|---|--|
| 1 Nancy Olbrys
Sharon Hewitt
Patricia Best
Deb Sandlin | 13 Ginny Meyer
Angie Wampler
Ken Fitzpatrick | 25 Nancy Matthews
Bruce Smith
John Bonner |
| 2 Sue Larson
Bryan Fisher
Sheldon King | 14 Ruby Schwartz | 26 John Birch
Bob Kuss |
| 3 Penny Pelfrey
Anna Lehmann
Claire Pelc
Eunice Sorber
Catherine Rivera | 15 Peggy Masi | 27 Dave Story
Jack Emery
Donna Denommee |
| 5 Betty Wagoner | 16 Jane Stickwood
Elna Mercer | 28 Mikie Morra
Robert Kramer
Monty Hey
Dave Schnitz
Sheryl Jecklin |
| 6 Twila Viscosi
James Prina | 17 Jayne Scheitler
Walt Steiert
Kay Smith
Ida Lawrence
Wilma Moses
Alan Arnett | 29 Joan Bilinski |
| 7 Chris Engell
Barb Blanchard | 18 Vincent Osika | 30 Kristina Chermak
Kathleen Eaton |
| 8 Lena Pease
Ginny Forsaith
Mark Blanchard
Sheila Johnson | 19 Sandy Parker | |
| 9 Rose Marie Fernald
Dee Bright | 20 Kim Swanson
Theresa Drnec
Virginia Preble | |
| 10 Tracy Dubois | 21 Mike Reid
Bill Gilding | |
| 11 Alan Wheeler | 22 Carolyn Dilks
John DeLorenzo
Mary Lowe | |
| 12 Kevin Holland | 23 Marie Holland | |
| | 24 Mike Frisbey
Ron Burns | |

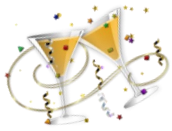

Happy November Anniversaries



- | | |
|---|--|
| 2 Rob & Cindy Dougherty
Glen & Carole Turenne
Peter & Jo Pike | 17 Jerry & Kathy Byron |
| 3 Jim & Carolyn Jones | 18 Russ & Nancy McGinnis |
| 4 Reed & Virginia Bannon
Thomas & Kathleen Fredrickson | 21 Kent & Janelle Bourg
Kurt & Nancy Deaner |
| 7 Paul & Valerie Bell | 22 Neil & Denise Murchinson |
| 11 Andy & Patsy Sokol | 23 Mike & Connie Frisbey |
| 13 Rick & Paula Mitchell
Sheldon & Claudette King
George & Lois Seymour | 24 Dennis & Julie Somers |
| 15 Robert Branquet & Carol Ann Belanger
Alan & Terri Arnett | 25 Don Simpson & Bonnie Dean |
| | 27 Garry & Linda Chickery |
| | 30 David & Betty Pelley |

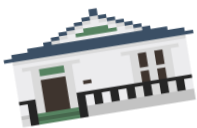

Welcome New Residents

- | | |
|--------------------------|-------------------------|
| Larry & Linda Kazda | 6335 Jessup Drive |
| Elghali (Adam) Elkettani | 41309 Whitmer Drive |
| George Worley | 6241 Presidential Drive |
| Norma Deeds | 6067 Forest Lake Drive |
| Jilla Martin Hardy | 6243 Forest Lake Drive |
| Ruth Barnes | 5948 Utopia Drive |



Central Florida **Pest** Control

Billy Hill



26077 Pumpkin Path
Brooksville, FL, 34602
(352) 585-3236

**Decorative
DRIVEWAYS**

DecorativeDrivewaysLLC.com

813-433-6605

PATIOS | GARAGES | DRIVEWAYS
WALKWAYS | POOL DECKS | PAVERS

LEE REED INSURANCE

Home • Mobile Home • Automobile • Annuities



Call or stop by today!

(813)782-5502

www.leereedinsurance.com

38511 5th Ave. in Downtown Zephyrhills

Since 1946



Paint with Judy

If we can't paint it... we'll burn it!

Acrylics, Watercolor,
or Woodburning

Let's Party!

Book your holiday party now!

Call Judy Thiese... 813-862-5013

MOBILE HOME ROOFING



FREE

VIDEO ROOF INSPECTIONS

- Lifetime Transferable Warranty
- Energy Efficient
- Protects Your Home
- Roof Insurance Certifications
- Financing Available
- FREE Estimates

LICENSED & INSURED #CCC1327406 • CBC1259006



**All Florida
Weatherproofing
& Construction, Inc.**

Family Owned
& Operated

1.877.572.1019

www.AllFloridaRoofs.com



National Days for the Month for NovemberPlan your days accordingly

November 1 - National Authors Day and Daylight Savings Time Ends
 November 2 - National Deviled Egg Day
 November 3 - National Sandwich Day and Election Day
 November 4 - National Stress Awareness Day
 November 5 - National Doughnut Day
 November 6 - National Nachos Day
 November 7 - National Bittersweet Chocolate with Almonds Day
 November 8 - National Cappuccino Day
 November 9 - National Awareness Day
 November 10 - Marine Corps Birthday and National Vanilla Cupcake Day
 November 11 - Veteran Day
 November 12 - National French Dip Day
 November 13 - World Kindness Day
 November 14 - National Pickle Day
 November 15 - National Raisin Bran Cereal Day

November 16 - National Fast Food Day
 November 17 - National Homemade Bread Day
 November 18 - National Vichyssoise Day and Happy Birthday Mickey Mouse
 November 19 - National Play Monopoly Day
 November 20 - National Peanut Butter Fudge Day
 November 21 - National Gingerbread Cookie Day
 November 22 - National Cranberry Relish Day
 November 23 - National Cashew Day
 November 24 - National Sardines Day
 November 25 - National Jukebox Day
 November 26 - Thanksgiving Day and National Cake Day
 November 27 - National Day of Listening
 November 28 - National French Toast Day
 November 29 - Electronic Greetings Day
 November 30 - National Personal Space Day



Recycling Information

Plastic, Metal, Paper, Cardboard

The East Pasco Transfer Station accepts all recyclable material (**NO GLASS**). No need to sort, dump all into one bin. Turn left out of our park on Pasco Co 54W (becomes Eiland Blvd). Drive 6.9 miles, turn right onto 579N (Handcart Rd). Go about 3.9 miles, station is on right. Furniture and appliances for free. TVs are \$5 or \$10
 352-521-0500

PAPER & CARDBOARD

Paper & Cardboard Recycling is open on **Saturdays from 10am—noon**. Accepted items are clean, dry paper and cardboard. Please break down the cardboard boxes and remove metal staples and all tape. No plastic bags or shredded material.
DO NOT LEAVE ITEMS OUTSIDE OF THE COLLECTION AREA

CANS FOR KIDS

We collect **aluminum drink cans** to benefit CANS FOR KIDS. Please deposit **CLEAN, EMPTY** cans into the Blue barrels in the clubhouse area or place them in the wagons located at 6450 Presidential Circle and 5702 Viau Way

We are looking for new volunteers so that we are able to continue the recycling program. If you are interested in volunteering, please contact Janice Collins at 813-788-5678. Thank you!



JR GOLF CARTS LLC

Free Pickup & Delivery *The Best* **PRICE**
QUALITY • SERVICE

Authorized Dealer:

- Crown Batteries
- Electro Batteries

**Over 18 years of Reliable & Honest
Sales & Services for all Makes and
Models of Golf Carts.**

CRICKET, CLUB CARS, EZ GO, EVOLUTION & MORE

Zephyrhills 813-702-4913

Lakeland 863-667-0700

www.JRGolfCartsLLC.com

SAVE SAVE SAVE SAVE!

L A **Z** B O Y

Pinnacle

Live life Comfortably.



#512

\$799.95

Reclina-Way®
Love Seat

Rowan Rocker
Recliner



#765

\$399.95



MED-LIFT
#1175

2-Way Recliner with
Heat & Massage

Weight capacity 320 lbs.

Starting at

\$799.95

Brick City Sofas

TWIN, FULL, QUEEN
100's of Fabrics to Choose
From!

Starting
at

\$699.95



*Photo for illustration



FREE LOCAL DELIVERY

Lamplighter



**FURNITURE
COMPANY, INC.**

FAMILY OWNED & OPERATED FOR 38 YEARS



HOURS: M-F 9AM-4PM; SAT. 9AM-1PM

**\$20.00
OFF**

ANY IN-STOCK PURCHASE
OF \$300 OR MORE.

Must present coupon. Offer valid on in stock merchandise only. Not valid on specials or clearance merchandise. One per household.

L A **Z** B O Y



38515 5TH AVE., DOWNTOWN ZEPHYRHILLS

788-3680

www.LamplighterFurniture.com

Visit our showroom for a huge selection of quality furniture.
100's of styles and fabrics to choose from!



UNDERHOME ARMOR.

Quality Workmanship
Honest Pricing

- Vapor / Moisture Barrier
- Underhome Encapsulated Insulation
- Hurricane Tie-Down Anchors

**8 Yrs
Exp.**



We Keep rodents,
snakes, spiders, bugs,
mold, mildew, and
damaging moisture out
of your home!

LIC. # IH-1110636
INSURED

FAMILY
OPERATED



ESTIMATES &
SMILES ALWAYS FREE



(800) 377-7885 or (352) 474-5644



BE CAREFUL PEOPLE
THEY ARE OUT THERE
I MEAN ROCKS, OF COURSE



To Bev Onken and Joan Kubara, who always seem to be available on a moments notice. I appreciate your proof reading skills!!

thank you!

From the Editor— Thank you for supporting your newsletter. Articles, questions or announcements that you want printed in the newsletter should be submitted by the 20th day of the previous month” (ie. December newsletter items should be submitted by December 20th.) Send all items to

EditorFLEnewsletter@gmail.com



Please do not park on sidewalks or grass

Propane

Drop tank at RV office before 11 am, pick up after 4 pm. If after 11 am pick up next business day

Must pre pay inside office before tank will be filled

Cannot fill tanks older than 12 years unless they have been recertified and tagged

Rates are as follows:

- 20 LB Tank \$15
- 30 LB Tank \$20
- 40 LB Tank \$30



Price per Gallon \$3.00

Happy Thanksgiving



FOREST LAKE ESTATES

Resident Concern Form

Date: _____

Resident Name(s): _____

Address and Site Number: _____

Telephone Number: _____

Incident or Problem Detail

Date of Incident or problem: _____

Resident(s) or Person(s) Name(s): _____

Locations(s) of Incident or Problem: _____

Description of Incident(s) or Problem(s): _____

Resident Signature: _____ Date: _____

Resident Signature: _____ Date: _____

Date Received in Management Office _____

Received By: _____

Action Taken: _____

Community Manager's Signature _____

LOOKED UNDER YOUR MOBILE HOME LATELY?



Insist on 8 Ft. Wide Vapor Barrier for a Seamless Fit!

OVER 10,000 VAPOR BARRIERS INSTALLED!

WE ALSO SPECIALIZE IN MOBILE HOME FLOORING REPAIRS, AND LAMINATE FLOORING.

WE CAN FIX YOUR SOFT FLOORS!



**FLORIDA
ANCHOR AND BARRIER
COMPANY**



**ESTIMATES
ALWAYS FREE
FAMILY OWNED
& OPERATED**

**813.528.5988
800.681.3772**



**STATE CERTIFIED GENERAL
CONTRACTOR**

004138

**STATE CERTIFIED
MOBILE HOME INSTALLER**

#IH/102549/1

**SENIOR
APPROVED** 

**SENIOR OR
MILITARY DISCOUNTS**





One of America's Best Hospitals

for Heart Care, Orthopedics,
Patient Safety and
Stroke Centers

2017-2020



IMPERIAL

PAINTING & PRESSURE WASHING
CONTRACTORS



"From Pillar to Post ,Call the Crew that can do the Most"



Painting and Staining
Wallpaper Hanging & Removal
Carpentry Services
Crown moldings
Chair Rail installation
Wood & Laminate flooring
Tile Flooring and backsplash
Window and door installs
Pressure cleaning services

Over 30 years of experience back this family operated home Improvement business, We have become a trusted name for all your home improvement and maintenance needs

Call today for a Free Estimate
(813) 235-3925

imperialpant.us
gokeyinc@aol.com

NOVEMBER 2020

Sunday	Monday	Tuesday	Wednesday	Thursday	Friday	Saturday
1	2	3	4	5	6	7
	10am - 12 noon - Ticket Sales	10am - 12 noon - Ticket Sales				
8	9	10	11	12	13	14
	10am - 12 noon - Ticket Sales 4:30 - 5:30pm - Monday Night Sandwiches (advance tickets required)	10am - 12 noon - Ticket Sales 11am - New Resident Welcoming Orientation (advance registration)	11am - Veterans Day Ceremony 			8am - 1pm Park Wide Yard Sale 8:30am - 1 pm - Bloodmobile
15	16	17	18	19	20	21
6pm - 7pm - Ice Cream Social (advance tickets required)		4:45 - 5:45pm Bingo Sales 6pm Bingo				
22	23	24	25	26	27	28
		11am - New Resident Welcoming Orientation (advance registration) 4:45 - 5:45pm Bingo Sales 6pm Bingo				
29	30					

(K) - Kirchen Side (S) - Stage Side (P) - Patio (MM/DD) - Start Date

Check www.fle-hoa.com for updates to the Social and Activities Calendars

IMPORTANT INFO ON TICKET SALES

Nov 2nd and 3rd - tickets will be sold for the Monday Night Sandwich event being held on November 9th. Advance tickets are required.

Nov 9th and 10th - tickets will be sold for the Ice Cream Social being held on Sunday, November 15th. Advance tickets are required.

SUB-FLOOR & FLOORING EXPERTS!

Sub-Floor Repairs



Laminate Flooring



FREE
ESTIMATES

30
YRS
EXPERIENCE

STATE CERTIFIED
GENERAL CONTRACTOR
CGC# 004138

STATE LICENSED
MOBILE HOME INSTALLER
IH# 102549/1

LICENSED
INSURED
BONDED

FLORIDA
ANCHOR AND BARRIER
COMPANY



813.528.5988

800.681.3772

NOVEMBER 2020 FLE RECURRING EVENT ACTIVITES SCHEDULE

time	SUNDAY	MONDAY	TUESDAY	WEDNESDAY	THURSDAY	FRIDAY	SATURDAY
8:30 am		Tennis Round Robin	Tennis Round Robin	Tennis Round Robin	Tennis Round Robin	Tennis Round Robin	Tennis Round Robin
9:00 am		Senior Exercise Horseshoes Practice	Horseshoes Practice	Senior Exercise Horseshoes Practice	Horseshoes Practice	Senior Exercise Horseshoes Round Robin	
9:30 am		Shuffleboard	Shuffleboard	Shuffleboard	Shuffleboard	Shuffleboard	Pass the Ace Shuffleboard
9:45 am							
10:00 am		Woodcarving (11/12)	Pickle Ball Drop In Yoga	Pickle Ball Drop In	Woodcarving (11/15) Pickle Ball Drop In Yoga	Pickle Ball Drop In	Pickle Ball Drop In
10:45 am							
11:00 am		Pool Exercises		Pool Exercises Quilting		Pool Exercises	
12:00 pm					Mahjongg		
12:30 pm							
1:00 pm	Pool Volleyball	Pool Volleyball	Pool Volleyball	Pool Volleyball	Pool Volleyball	Pool Volleyball	Pool Volleyball
2:00 pm							
3:00 pm		Party Hardy Putt Putt		Party Hardy Putt Putt			
4:30 pm				Party Hardy Putt Putt			
4:45 pm			Bingo Sales (11/17)				
5:00 pm		Horseshoes Practice	Horseshoes Practice	Horseshoes Practice	Horseshoes Practice		
5:45 pm			Bingo Sales End				
5:50 pm					Texas Hold'Em Registration ends		
6:00 pm		Putt Putt Social Hand n Foot	Bingo (11/17) Hand n Foot (RV)		Hand n Foot Texas Hold'Em (S)		
6:30 pm				Dominos (S)			
6:45 pm							
7:00 pm						Foto Club (P)	
7:30 pm							
8:00 pm							

K) Kitchen Side (S) Stage Side (C) Card/HOA room (PP) Ping Pong room (P) Patio (RV) RV Clubhouse (MM/DD) start d